

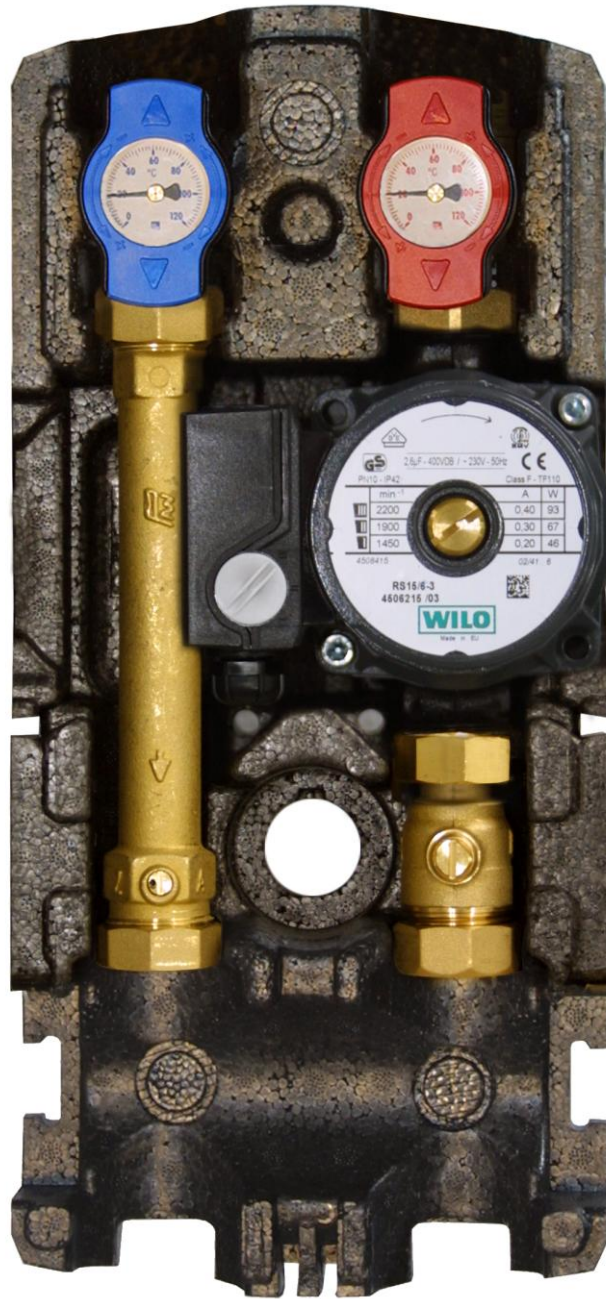

In North America for Technical Assistance
Contact Solarnetix Inc. 416/699-6746
www.solarnetix.com / info@solarnetix.com

Installation and User Guide

High Temperature Zone Module K31
- Residential series – 3/4"



08/2006

Note: Product Information is subject to change without notice and supersedes all previous publications.

Scope of Supply

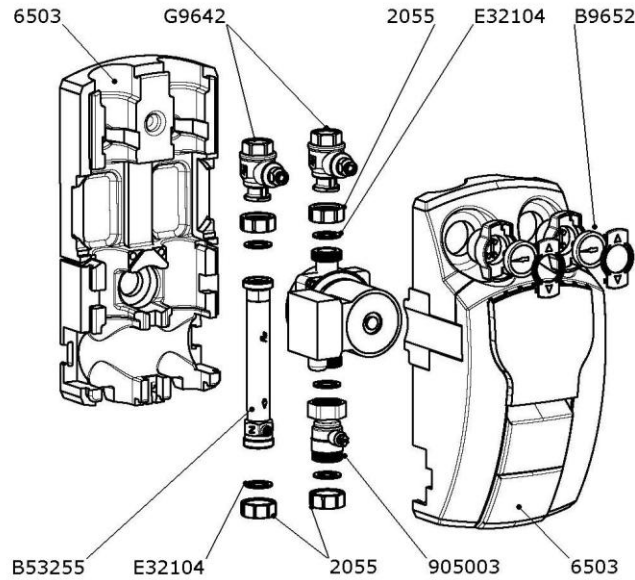

Pos.	Art. Code	Description	Quantity
1	G9642	Ball valve with integral thermometer 3/4"	2
2	B53255	Return pipe, brass, 3/4" x 188 mm/ 7.4 inch	1
3	905003	Pump ball valve, 3/4" x 1" BSP Male	1
4	Circulator	Heating circulation pump, 115 V, 60 Hz	1
5	B9652	Set of thermometer handles (red/blue) for heating DN20, 0-120°C/30-250°F	1
6	2055	Union nut DN¾", 1"F, brass	4
7	E32104	Gasket for union nut 1", EPDM	5
8	6503	Set of thermal insulation shells for heating zone module 3/4" V404	1

Technical Data

High temperature zone module K31- residential series – ¾"

Material	
Fittings	Brass
Seals	NBR / EPDM
Thermal insulation	EPP
Specifications	
Maximum operating pressure	8 bar/116 psi
Maximum supply temperature	110°C/230°F; short-term 130°C/260°F
Dimensions	
Inlet	1" BSP male thread flat seat
Outlet	3/4" BSP female thread
Distance	90 mm / 3.5 inch
Overall length	255 mm / 10 inch
Height of thermal insulation	385 mm / 15.15 inch
Width of thermal insulation	180 mm / 7.09 inch

General Information

PAW heating zone modules are designed so that they can be mounted directly onto a PAW modular distribution manifold. If necessary, PAW heating zone modules can be inverted from design type “Right - hand supply” to “Left –hand flow” and the other way round.

Additionally PAW heating zone modules can be equipped with a pressure bypass valve.

The integrated flow check valve prevents wrong circulation in the return line of the PAW heating zone modules. If necessary, this device can be opened intentionally.

Instructions for Installation and Commissioning

Safety Instructions

Make sure that only skilled and trained professionals are carrying out installation.

Do not use technical equipment that is defective or broken!

All operations must be conducted in accordance with the national Building Code regulations and local Electrical Code rules!

For installation in foreign countries please see your corresponding institutions for information on regulations and safety measures.

Only skilled and trained electrical personnel are authorized to carry out wiring operations. All field wiring made during installation must comply with:

- **National Electrical Code NFPA 70 and any other national, state, provincial or local codes or requirements.**
- **In Canada, CSA C22.1 Canadian Electrical Code Part 1, and any other local codes!**

Flow Check Valve

All PAW heating zone modules are equipped with a flow check valve integrated into the return pipe. The flow check valve is spring-loaded. Opening pressure is 200 mm / 8” water column.

The flow check valve has to be put into open position for filling, drainage and venting. Put the adjusting pin into „A“= **(open)** position (see black mark).

During operation this pin must be in “Z” position (closed)!

Instructions for Supply Port Changeover

Lift forward and remove the front thermal insulation shell. Hold in place the thermometer handles to prevent them from falling out. Remove rear thermal insulation shell above the return pipe.

PAW heating zone modules with integrated mixing valve: Adjust mixing valve following the assembly instructions for flow connection inversion.

Change return pipe and pump (together with the respective upper ball valve).

Pay attention to the flow direction of the pump! Turn the pump head so that the terminal box is showing to the top or centre of the group of valves and fittings.

Install thermal insulation shell only upon completion of installation and commissioning.

Start-Up

Before commissioning: make sure that all union nuts are fastened tightly.

Install thermal insulation only after pressure/leak test. Finally install the thermometers and handles.

WILO PUMPS

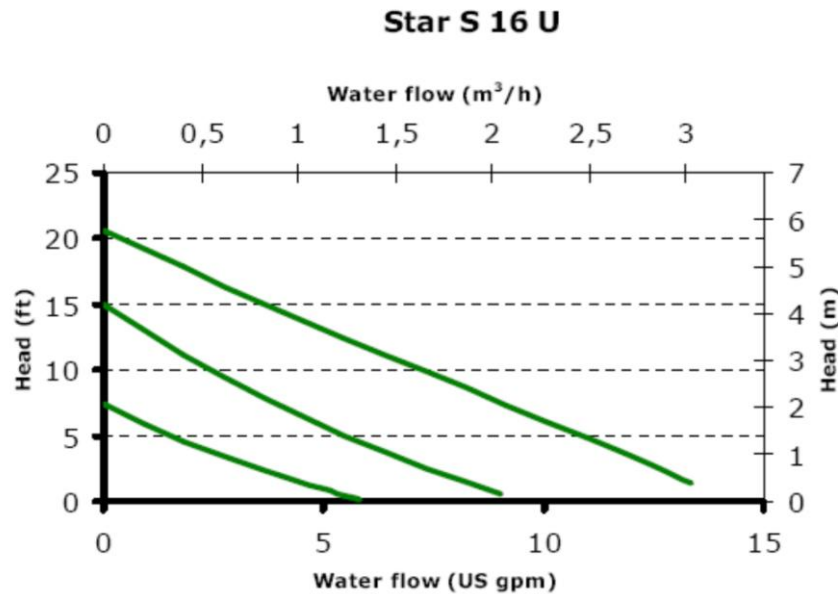

Limited Warranty

All Classic Star and Circo Star circulator pumps manufactured by WILO AG are warranted to the original user only to be free of defects in materials and workmanship for a period of 30 months from the date of manufacture or 24 months from the date of installation whichever expires first. WILO liability under this warranty shall be limited to repairing or replacing at WILO's option, without charge, F.O.B. the closest WILO distributor or service depot, any Classic or Circo Star pump.

WILO's Liability will be limited to the replacement or repair of the product. WILO will not be liable for any costs of removal, installation or transportation or any other charges which may arise in connection with a warranty claim. Limitation of liability may not be allowed in some regions please contact local representative for interpretation.

WILO warrants that its products are free from defects in manufacture. WILO will not be liable for damage or wear to products caused by miss application of product, improperly maintained systems, accident, abuse, misuse, unauthorized alteration or repair, or if the product was not installed in accordance with WILO's published installation and operation instructions. Please visit www.WILO-NA.com for a copy of our installation and operation instructions.

All claims under this warranty must be returned to an authorized WILO distributor for processing along with proof of purchase. Installation date and replacement date. WILO authorized distributor will then contact WILO for final product evaluation and processing.

WILO will not be liable for any damages that may arise through product failure. There are no express or implied warranties beyond those warranties described or referred to above. Limitation of liability may not be allowed in some regions please contact local representative for interpretation.

WILO

Important Note

These installation and use instructions have been designed carefully to the best of our knowledge and belief. The illustrations used are to be considered as conceptual.

Please note that due to the risk of editor's errors and misprints no responsibility is accepted for the correctness as regards content. Use of information contained in these instructions is made at the user's risk. The editor declines any liability for persons, property damage or especially direct, indirect, immediate or subsequent pecuniary loss resulting from improper, incomplete or wrong statements, details or instructions.